





# Bimetallic Thermometer, Bottom Mount

Model: MTB.S\_BS



## PRODUCT DESCRIPTION

▼  
Fixed angle, if you need to adjust the observing angle, you can refer to MTB.S\_BA

▼  
Suitable for applications in measuring industry, food industry and sewage treatment

## PRODUCT SPECIFICATION

**Connection location**  
Bottom mount

**Nominal size**  
3", 4", 5", 6"

**Scale ranges**  
-50°C ... 600°C

**Accuracy**  
CL 1.0

**Process connection**  
304 SS, 316 SS  
1/8, 1/4, 3/8, 1/2, 3/4  
PT, G, NPT, M

**Sanitary end cap**  
1", 1 1/2", 2", 2 1/2", 3", 4"

**Connection designs**  
Male thread, plain stem,  
compression fitting (sliding on stem),  
union nut and loose threaded connection,  
male nut, union nut, sanitary end cap,  
flange on stem

**Stem**  
304 SS, 316 SS  
Length:  
Above 40 mm (without thread)  
can be customized  
Diameter:  
6, 6.35, 8, 9.5, 10 mm

**Case/Ring**  
304 SS

**Window**  
Glass, safety glass

**Dial**  
Aluminum alloy  
Black scale on white

**Pointer**  
Black aluminum alloy

**Filling liquid**  
Without, glycerine

**Accessories (option)**  
Zero point setting with adjustment screw,  
thermowell, adjustable set pointer,  
drag pointer, spacer

**Protection**  
IP67

**DIMENSIONS**

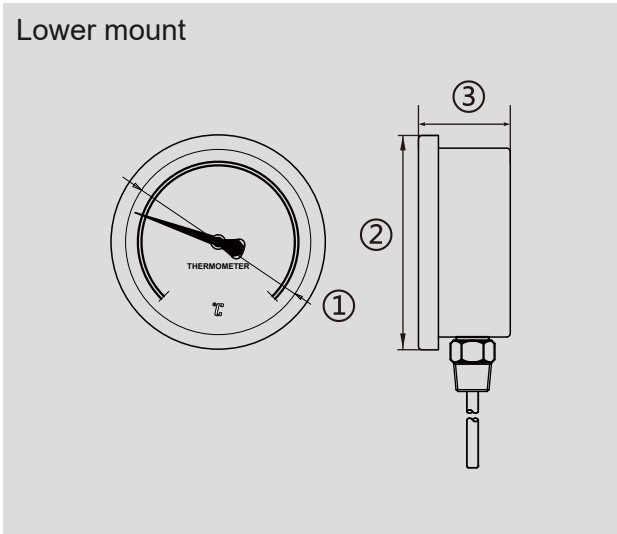

Dimensions (mm)			
NS	①	②	③
3"	70	85	47
4"	102	119	48
5"	110	127	51
6"	140	160	47

# CONNECTION DESIGN

Male thread

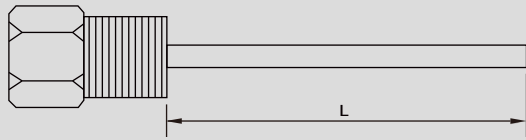

Plain stem

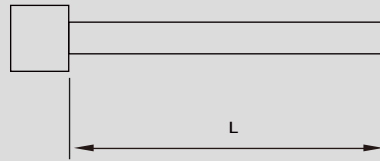

Compression fitting (sliding on stem)

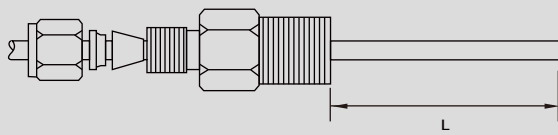

Union nut and loose threaded connection

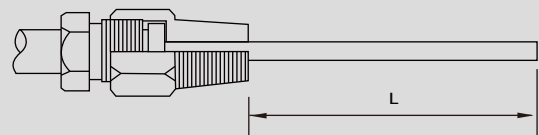

Male nut

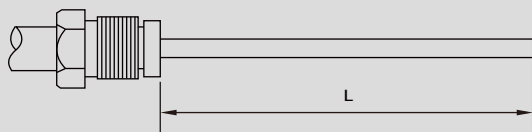

Union nut

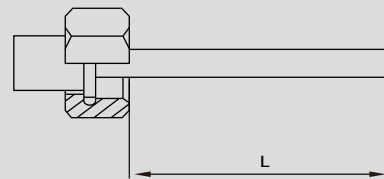

Sanitary end cap

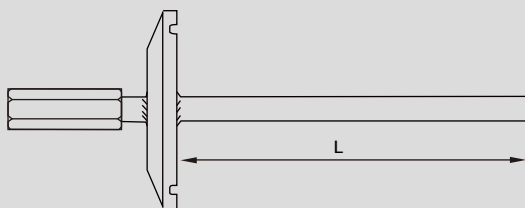

Flange on stem

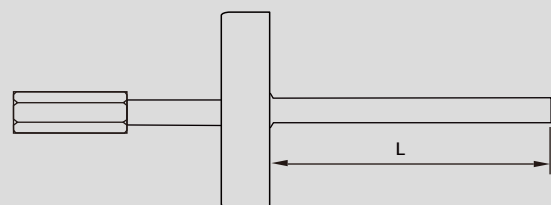

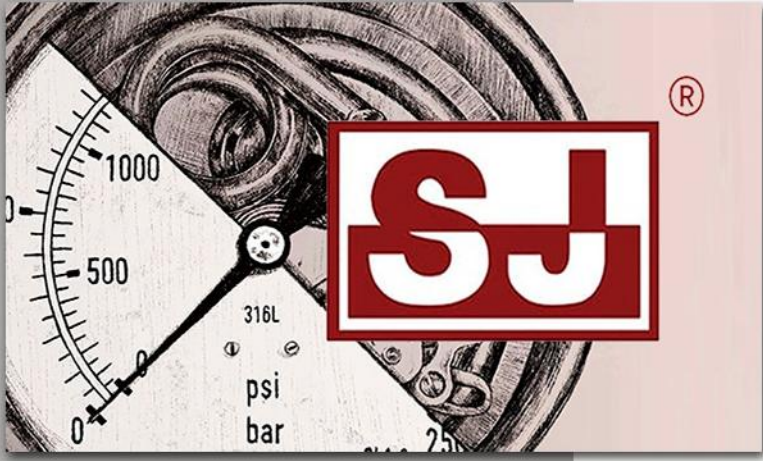

# rsIMMA

*Elementos For Manufacturing Purposes*



## **MEXICO BRANCH OFFICE**

Roberto Diaz No. 401  
Ciudad Industrial  
Aguascalientes, Ags.  
México  
20290

[4ManPro@4ManPro.com](mailto:4ManPro@4ManPro.com)

+52 (449) 171 3420

[www.4ManPro.com/SPA/](http://www.4ManPro.com/SPA/)

## **USA BRANCH OFFICE**

708 Main St.  
10<sup>th</sup> Floor  
Houston, Tx, USA  
77002

[4ManPro\\_USA@4ManPro.com](mailto:4ManPro_USA@4ManPro.com)

+1 (832) 871 5022

[www.4ManPro.com/ENG/](http://www.4ManPro.com/ENG/)